

Bipole III Transmission Project

Project Infrastructure

- Final Preferred Route
- Converter Station
- Local Study Area

Infrastructure

- Transmission Line

Structures

- Barn
- House
- Tower

Landbase

- Community
- City / Town
- Rural Municipality
- First Nation
- National/Provincial Park
- Wildlife Management Area

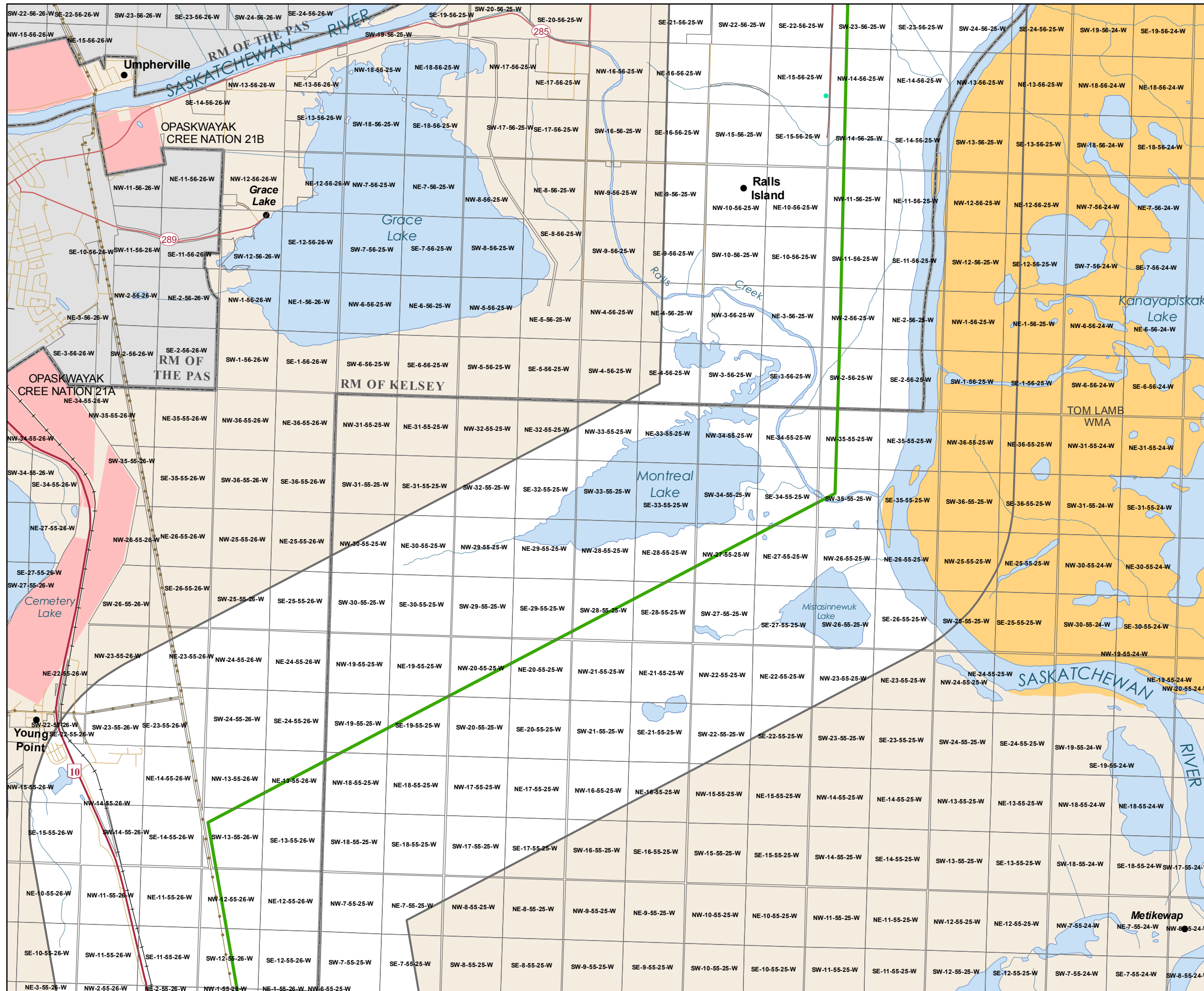

Coordinate System: UTM Zone 14N NAD83
 Data Source: MBHydro, MMM, Stantec, ProvMB, NRCAN
 J&V Nielsen
 Date Created: July 20, 2011

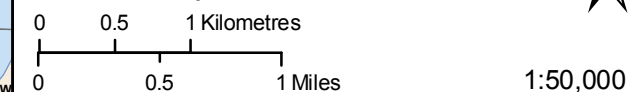

**Houses, Barns,
 And Structures
 Within 270 Metres Of The
 Final Preferred Route**

Bipole III Transmission Project

Project Infrastructure

- Final Preferred Route
- Converter Station
- Local Study Area

Infrastructure

- Transmission Line

Structures

- Barn
- House
- Tower

Landbase

- Community
- City / Town
- Rural Municipality
- First Nation
- National/Provincial Park
- Wildlife Management Area

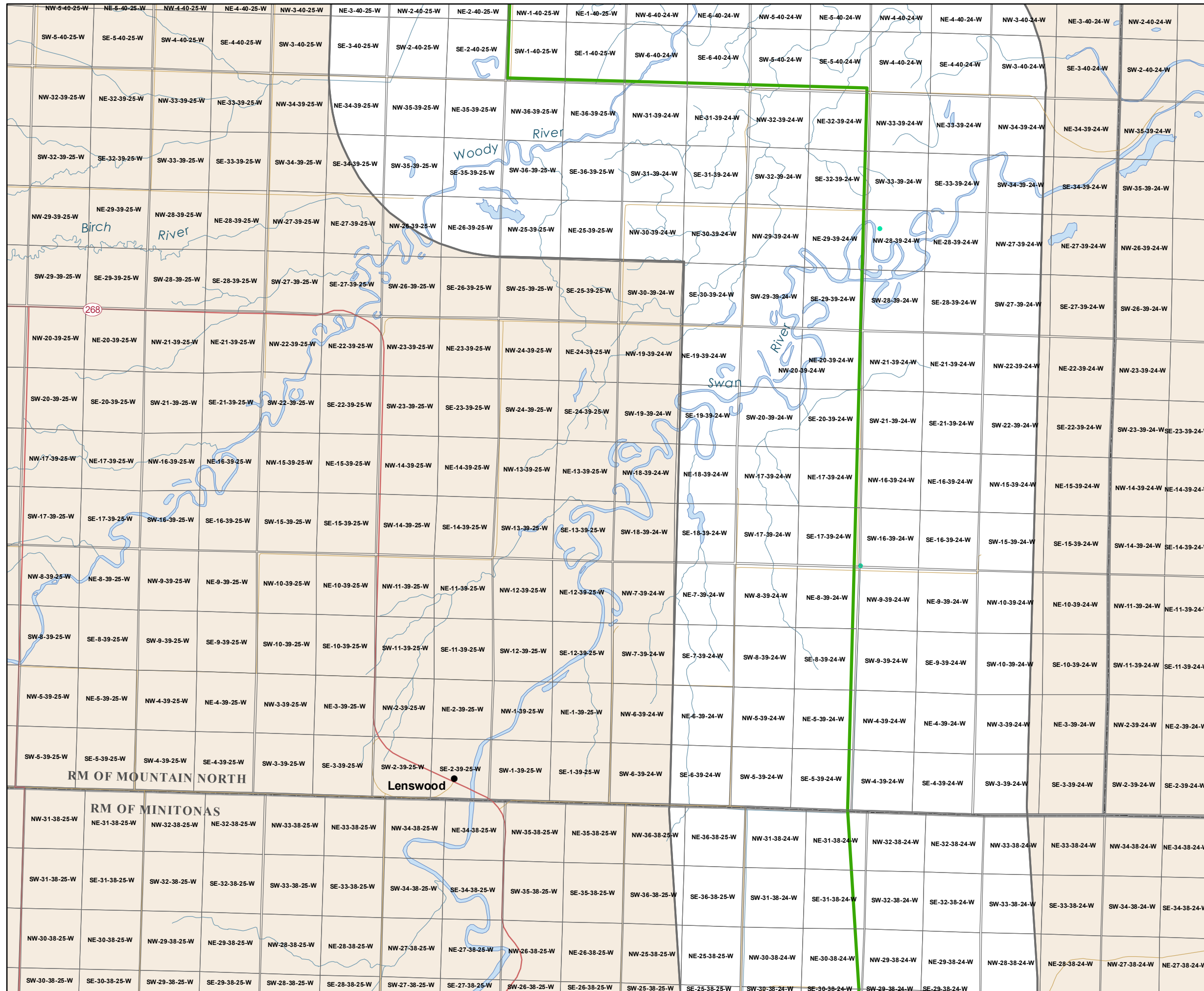

Coordinate System: UTM Zone 14N NAD83
 Data Source: MBHydro, MMM, Stantec, ProvMB, NRCAN
 J&V Nielsen
 Date Created: July 20, 2011

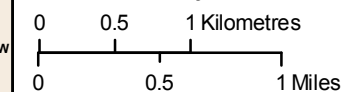

1:50,000

**Houses, Barns,
 And Structures
 Within 270 Metres Of The
 Final Preferred Route**

Bipole III Transmission Project

Project Infrastructure

- Final Preferred Route
- Converter Station
- Local Study Area

Infrastructure

- Transmission Line

Structures

- Barn
- House
- Tower

Landbase

- Community
- City / Town
- Rural Municipality
- First Nation
- National/Provincial Park
- Wildlife Management Area

Coordinate System: UTM Zone 14N NAD83
 Data Source: MBHydro, MMM, Stantec, ProvMB, NRCAN
 J&V Nielsen
 Date Created: July 20, 2011

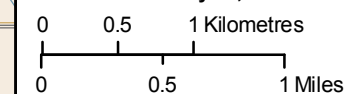

1:50,000

Houses, Barns, And Structures Within 270 Metres Of The Final Preferred Route

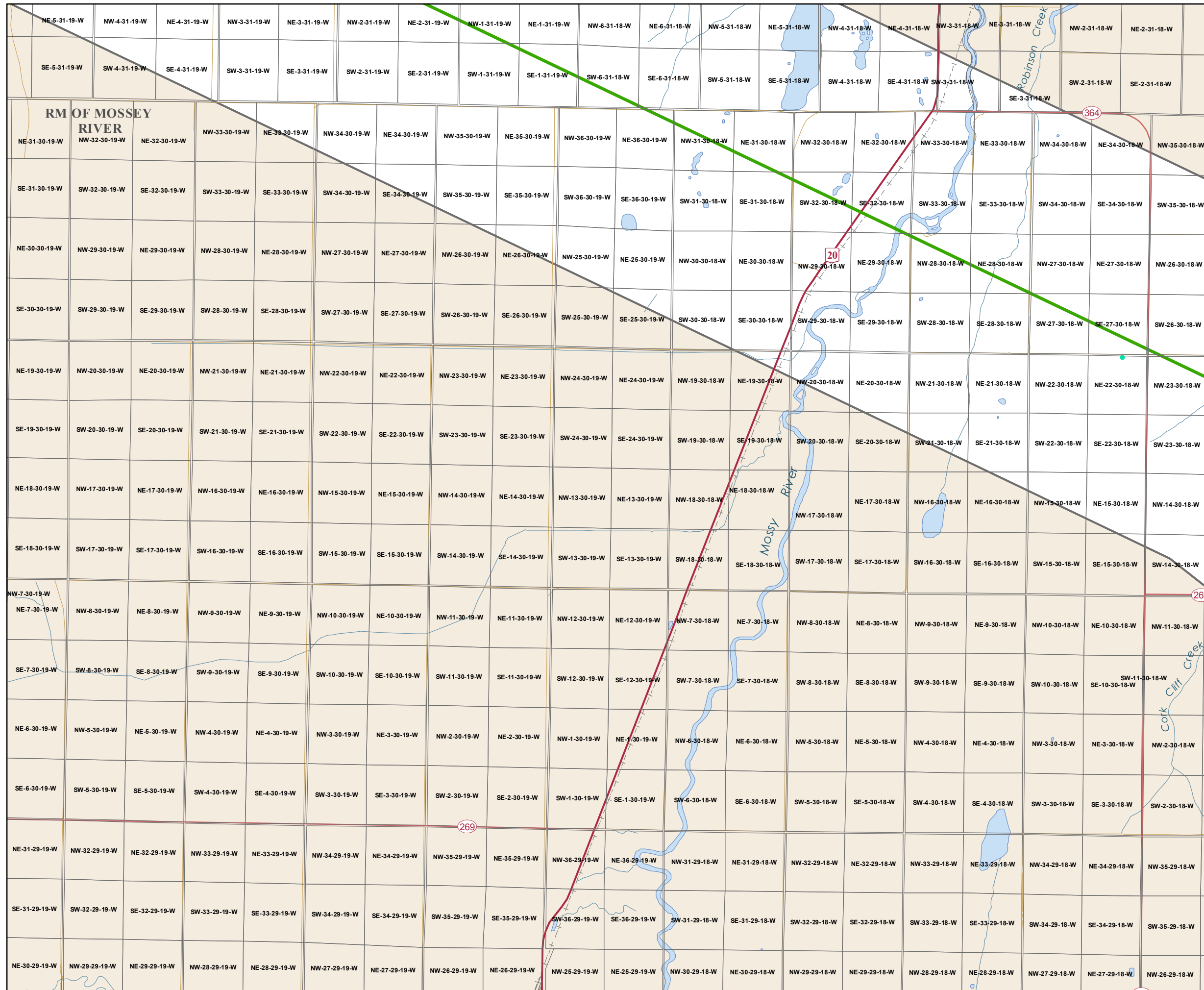

Bipole III Transmission Project

Project Infrastructure

- Final Preferred Route
- Converter Station
- Local Study Area

Infrastructure

- Transmission Line

Structures

- Barn
- House
- Tower

Landbase

- Community
- City / Town
- Rural Municipality
- First Nation
- National/Provincial Park
- Wildlife Management Area

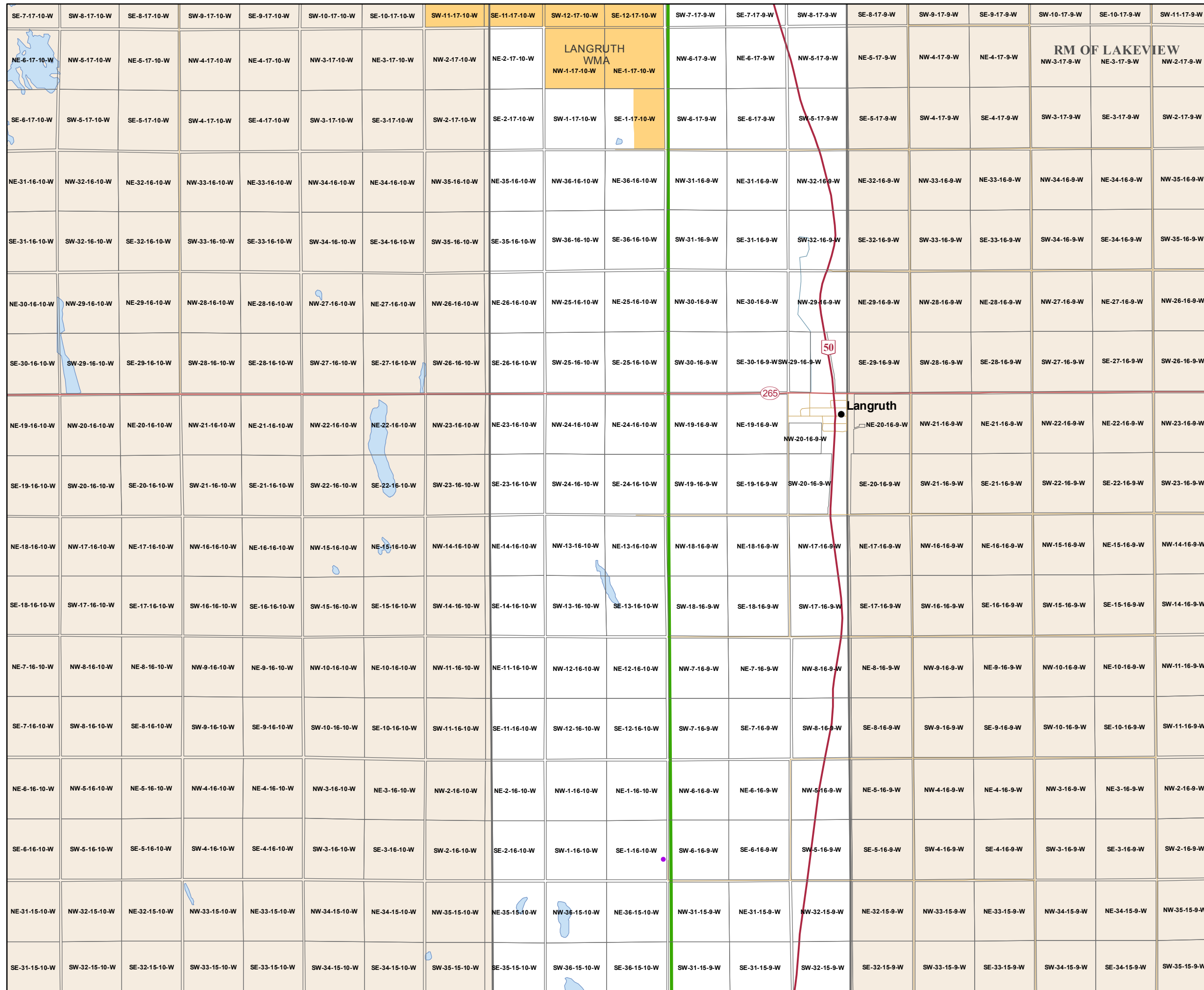

Coordinate System: UTM Zone 14N NAD83
 Data Source: MBHydro, MMM, Stantec, ProvMB, NRCAN
 J&V Nielsen
 Date Created: July 20, 2011

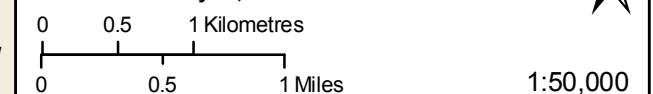

1:50,000

Houses, Barns, And Structures Within 270 Metres Of The Final Preferred Route

Bipole III Transmission Project

Project Infrastructure

- Final Preferred Route
- Converter Station
- Local Study Area

Infrastructure

- Transmission Line

Structures

- Barn
- House
- Tower

Landbase

- Community
- City / Town
- Rural Municipality
- First Nation
- National/Provincial Park
- Wildlife Management Area

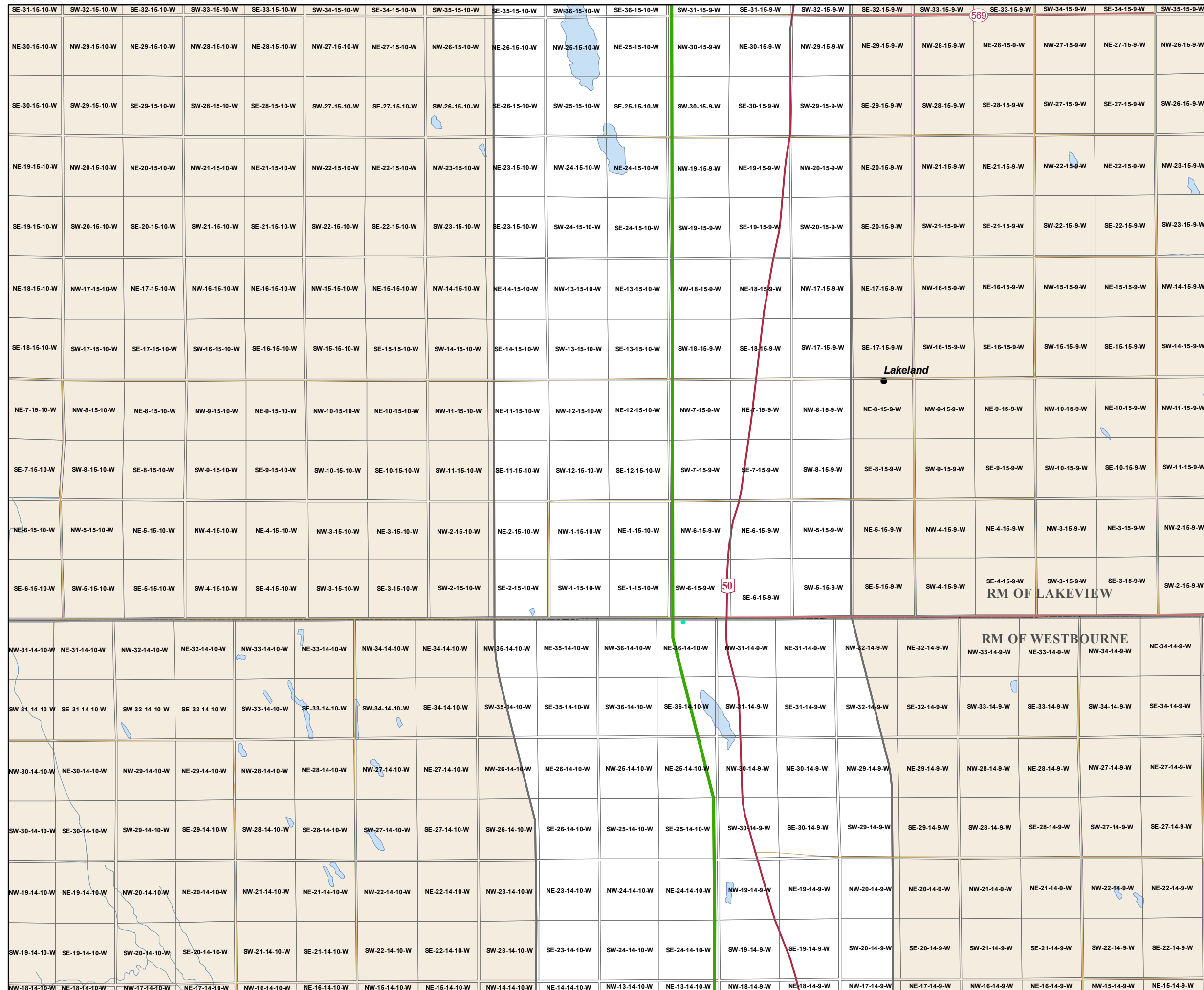

Coordinate System: UTM Zone 14N NAD83
 Data Source: MBHydro, MMM, Stantec, ProvMB, NRCAN
 J&V Nielsen
 Date Created: July 20, 2011

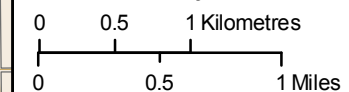

1:50,000

Houses, Barns, And Structures Within 270 Metres Of The Final Preferred Route

Bipole III Transmission Project

Project Infrastructure

- Final Preferred Route
- Converter Station
- Local Study Area

Infrastructure

- Transmission Line

Structures

- Barn
- House
- Tower

Landbase

- Community
- City / Town
- Rural Municipality
- First Nation
- National/Provincial Park
- Wildlife Management Area

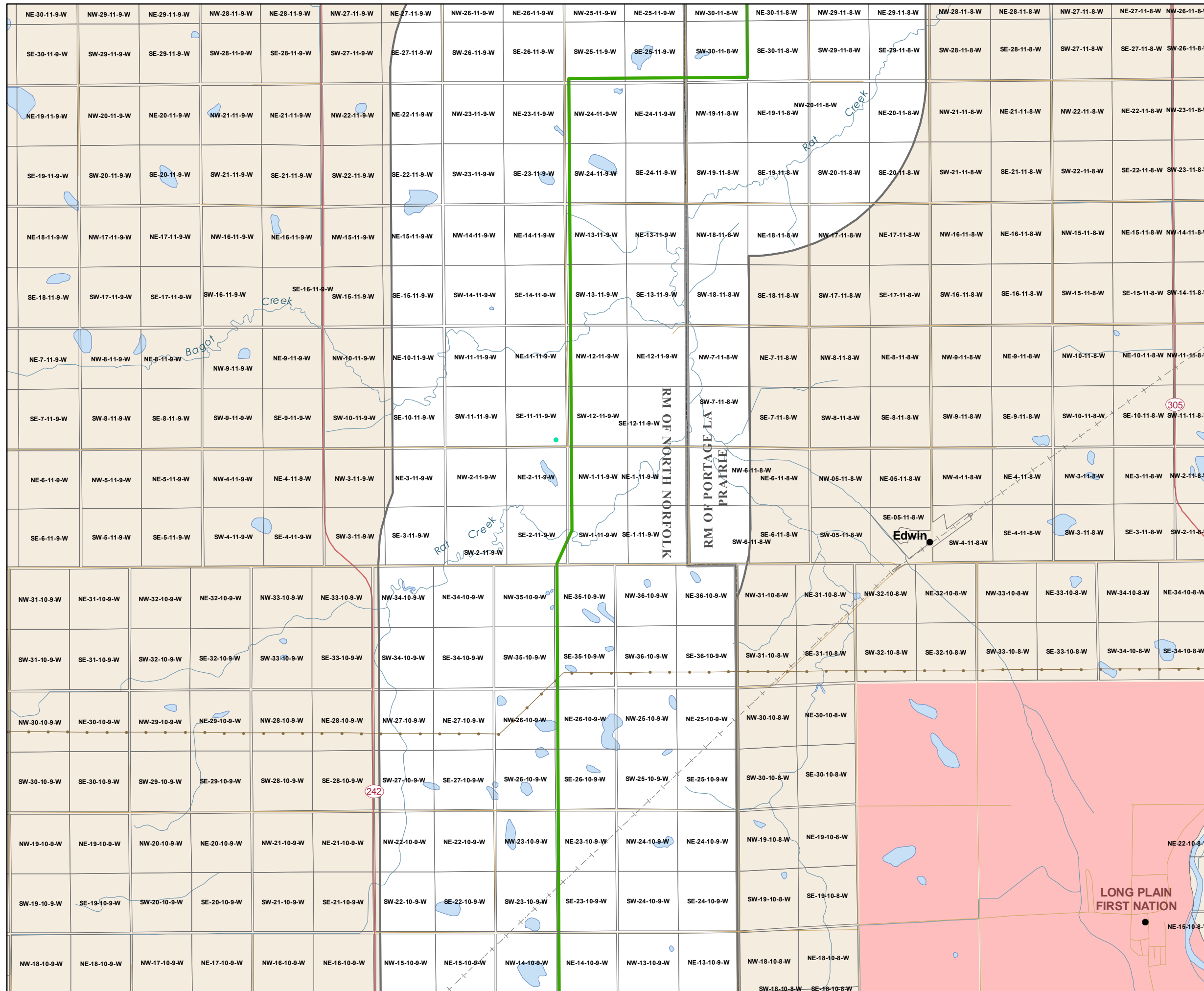

Coordinate System: UTM Zone 14N NAD83
 Data Source: MBHydro, MMM, Stantec, ProvMB, NRCAN
 J&V Nielsen
 Date Created: July 20, 2011

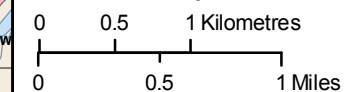

1:50,000

**Houses, Barns,
 And Structures
 Within 270 Metres Of The
 Final Preferred Route**

Bipole III Transmission Project

Project Infrastructure

- Final Preferred Route
- Converter Station
- Local Study Area

Infrastructure

- Transmission Line

Structures

- Barn
- House
- Tower

Landbase

- Community
- City / Town
- Rural Municipality
- First Nation
- National/Provincial Park
- Wildlife Management Area

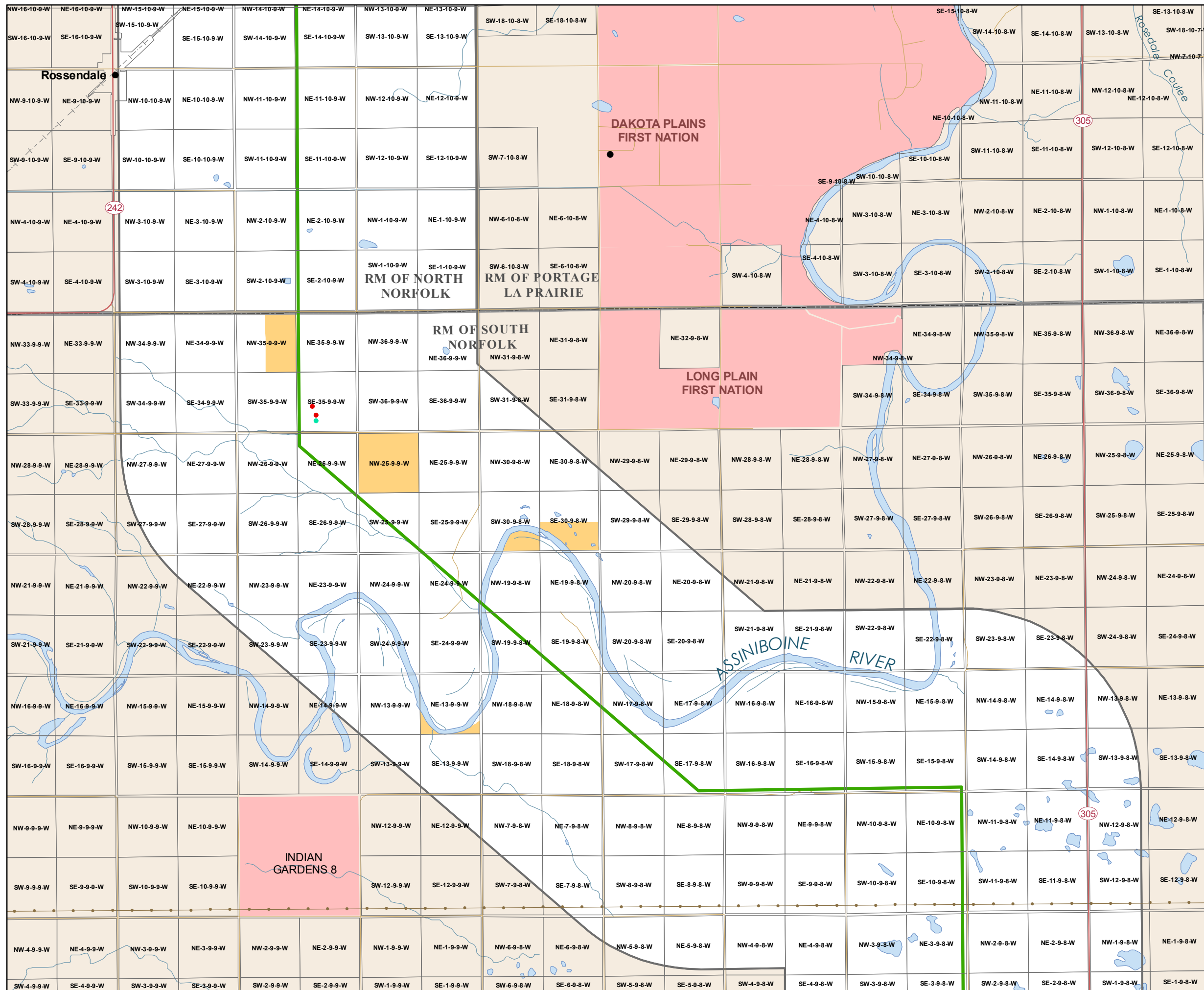

Coordinate System: UTM Zone 14N NAD83
 Data Source: MBHydro, MMM, Stantec, ProvMB, NRCAN
 J&V Nielsen
 Date Created: July 20, 2011

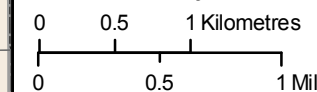

1:50,000

Houses, Barns, And Structures Within 270 Metres Of The Final Preferred Route

Bipole III Transmission Project

Project Infrastructure

- Final Preferred Route
- Converter Station
- Local Study Area

Infrastructure

- Transmission Line

Structures

- Barn
- House
- Tower

Landbase

- Community
- City / Town
- Rural Municipality
- First Nation
- National/Provincial Park
- Wildlife Management Area

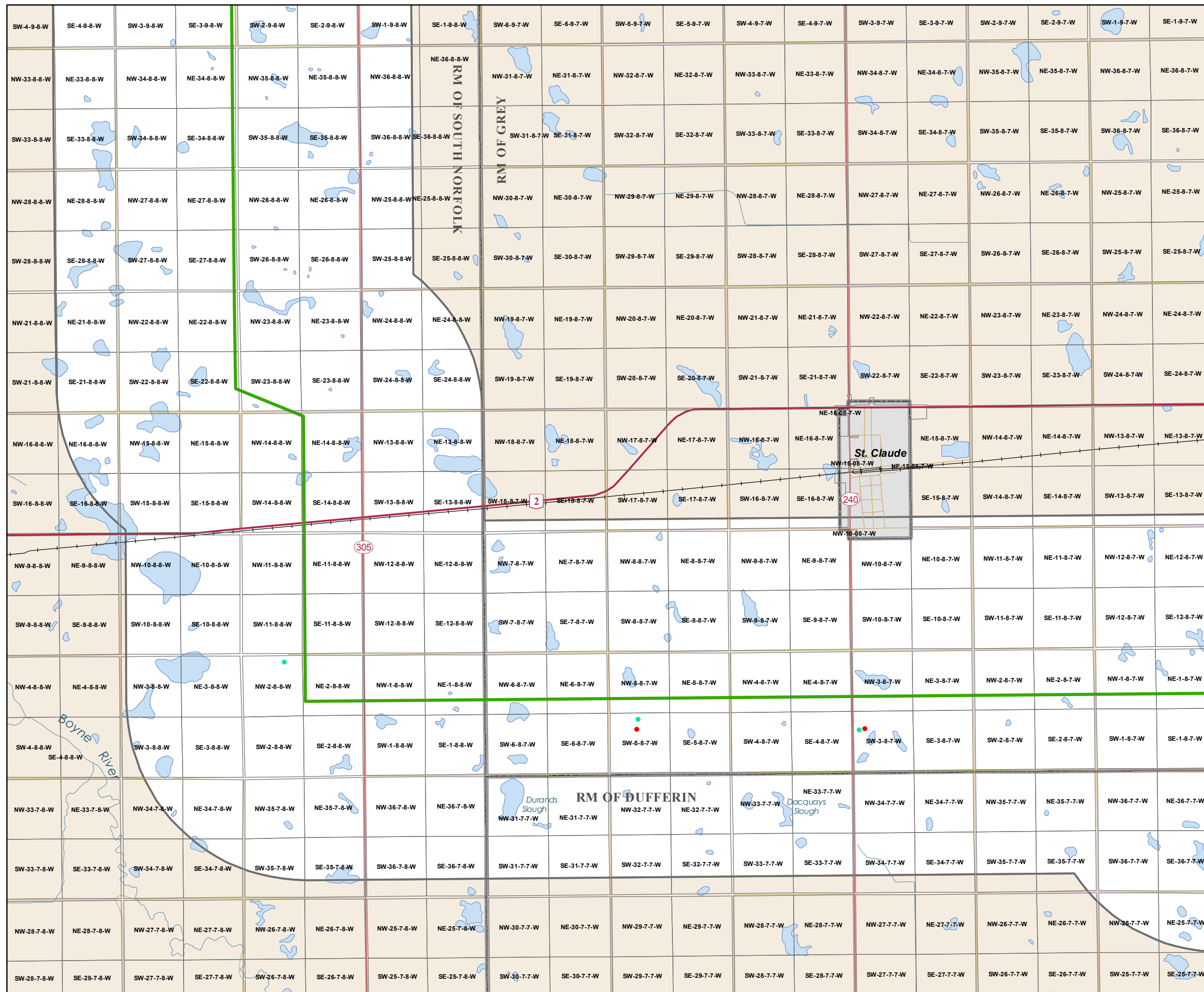

Coordinate System: UTM Zone 14N NAD83
 Data Source: MBHydro, MMM, Stantec, ProvMB, NRCAN
 J&V Nielsen
 Date Created: July 20, 2011

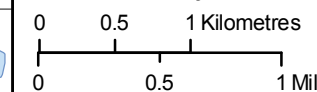

1:50,000

Houses, Barns, And Structures Within 270 Metres Of The Final Preferred Route

Bipole III Transmission Project

Project Infrastructure

- Final Preferred Route
- Converter Station
- Local Study Area

Infrastructure

- Transmission Line

Structures

- Barn
- House
- Tower

Landbase

- Community
- City / Town
- Rural Municipality
- First Nation
- National/Provincial Park
- Wildlife Management Area



Coordinate System: UTM Zone 14N NAD83
 Data Source: MBHydro, MMM, Stantec, ProvMB, NRCAN
 J&V Nielsen
 Date Created: July 20, 2011

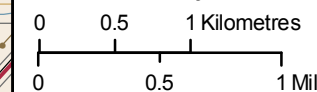

1:50,000

**Houses, Barns,
 And Structures
 Within 270 Metres Of The
 Final Preferred Route**

Bipole III Transmission Project

Project Infrastructure

- Final Preferred Route
- Converter Station
- Local Study Area

Infrastructure

- Transmission Line

Structures

- Barn
- House
- Tower

Landbase

- Community
- City / Town
- Rural Municipality
- First Nation
- National/Provincial Park
- Wildlife Management Area

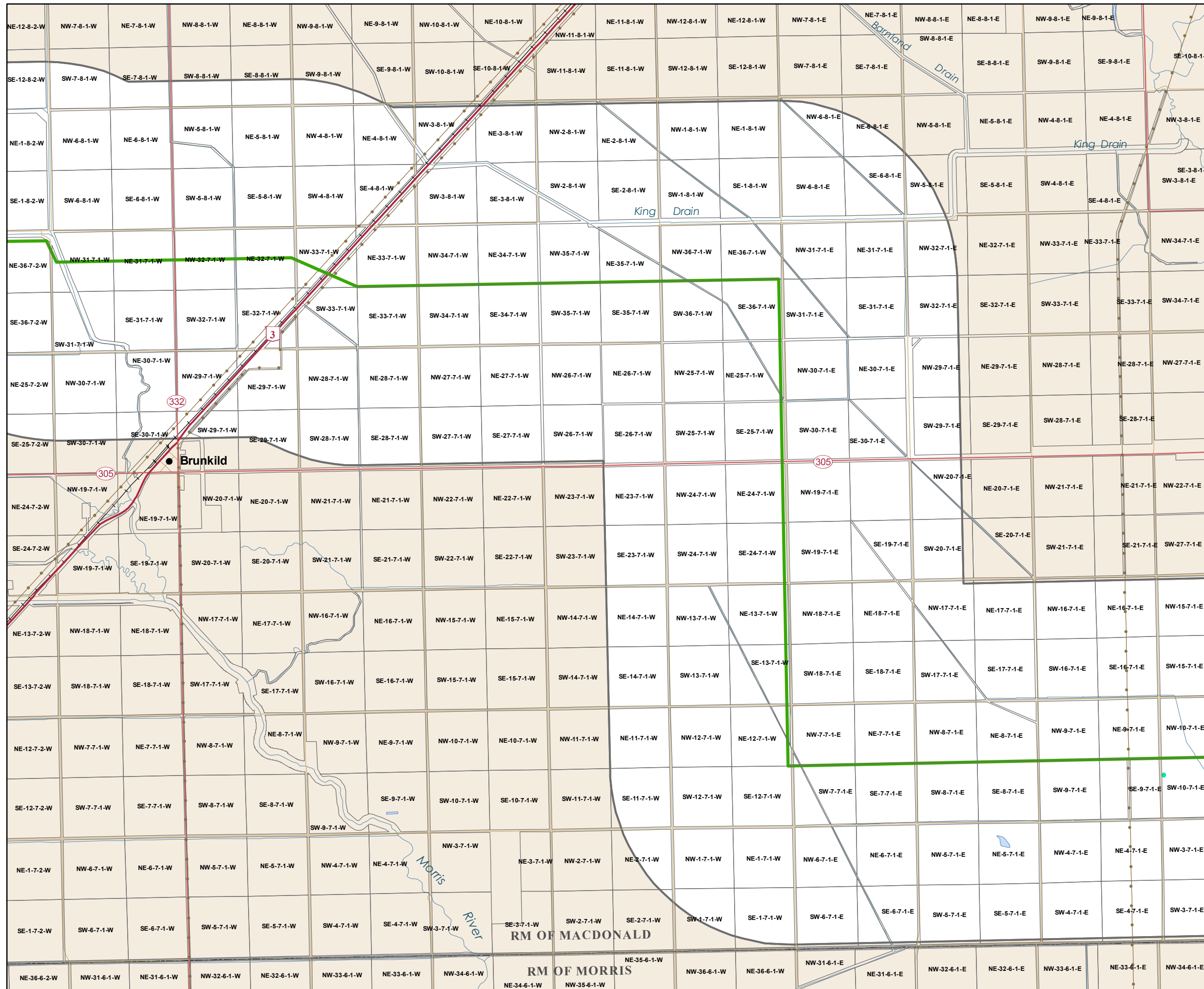

Coordinate System: UTM Zone 14N NAD83
 Data Source: MBHydro, MMM, Stantec, ProvMB, NRCAN
 J&V Nielsen
 Date Created: July 20, 2011

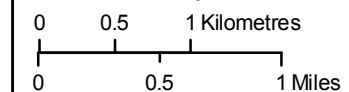

1:50,000

Houses, Barns, And Structures Within 270 Metres Of The Final Preferred Route

Bipole III Transmission Project

Project Infrastructure

- Final Preferred Route
- Converter Station
- Local Study Area

Infrastructure

- Transmission Line

Structures

- Barn
- House
- Tower

Landbase

- Community
- City / Town
- Rural Municipality
- First Nation
- National/Provincial Park
- Wildlife Management Area

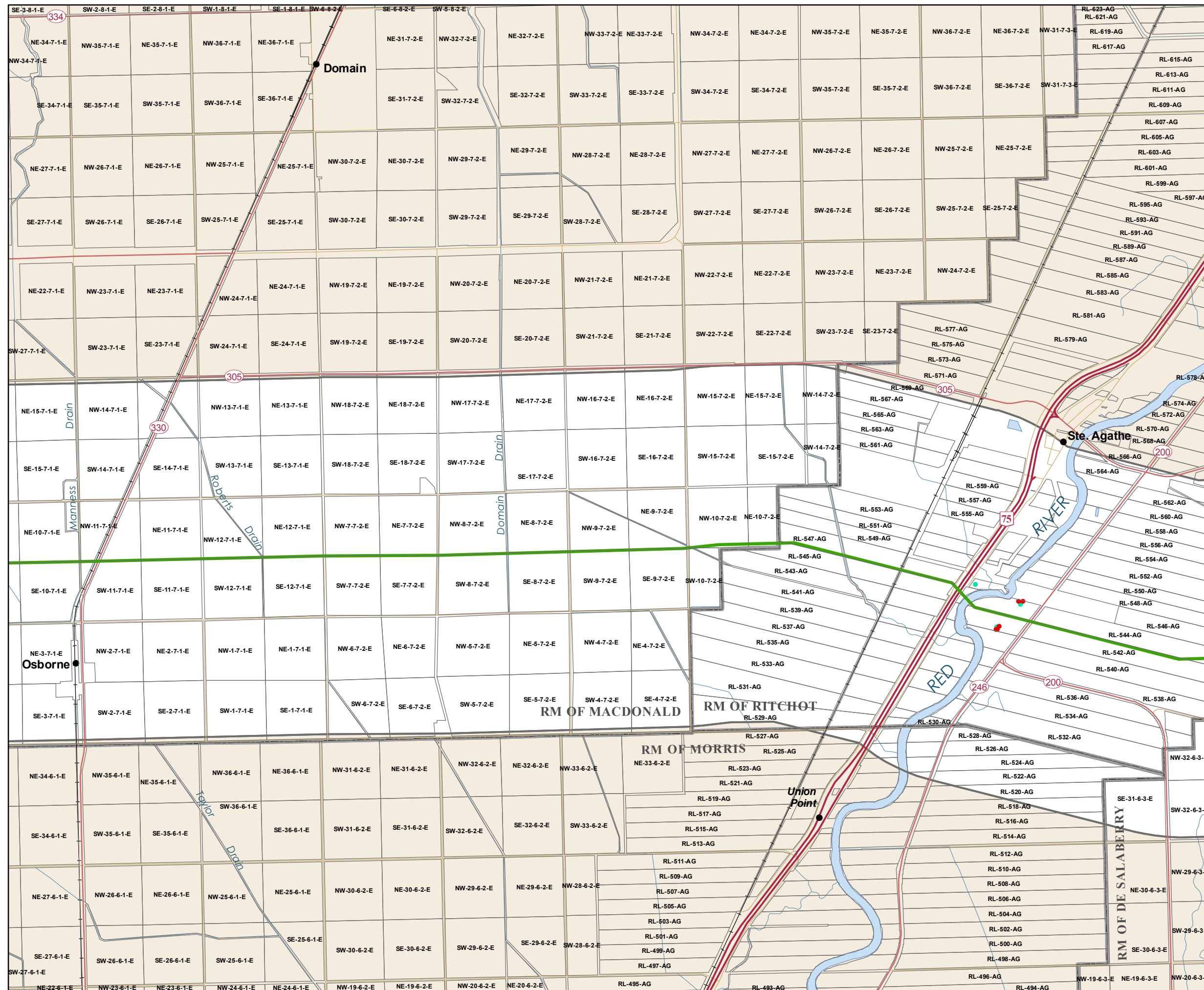

Coordinate System: UTM Zone 14N NAD83
 Data Source: MBHydro, MMM, Stantec, ProvMB, NRCAN
 J&V Nielsen
 Date Created: July 20, 2011

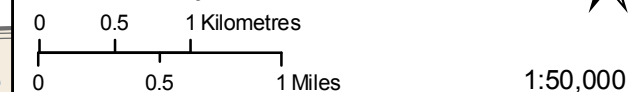

Houses, Barns, And Structures Within 270 Metres Of The Final Preferred Route

Bipole III Transmission Project

Project Infrastructure

- Final Preferred Route
- Converter Station
- Local Study Area

Infrastructure

- Transmission Line

Structures

- Barn
- House
- Tower

Landbase

- Community
- City / Town
- Rural Municipality
- First Nation
- National/Provincial Park
- Wildlife Management Area

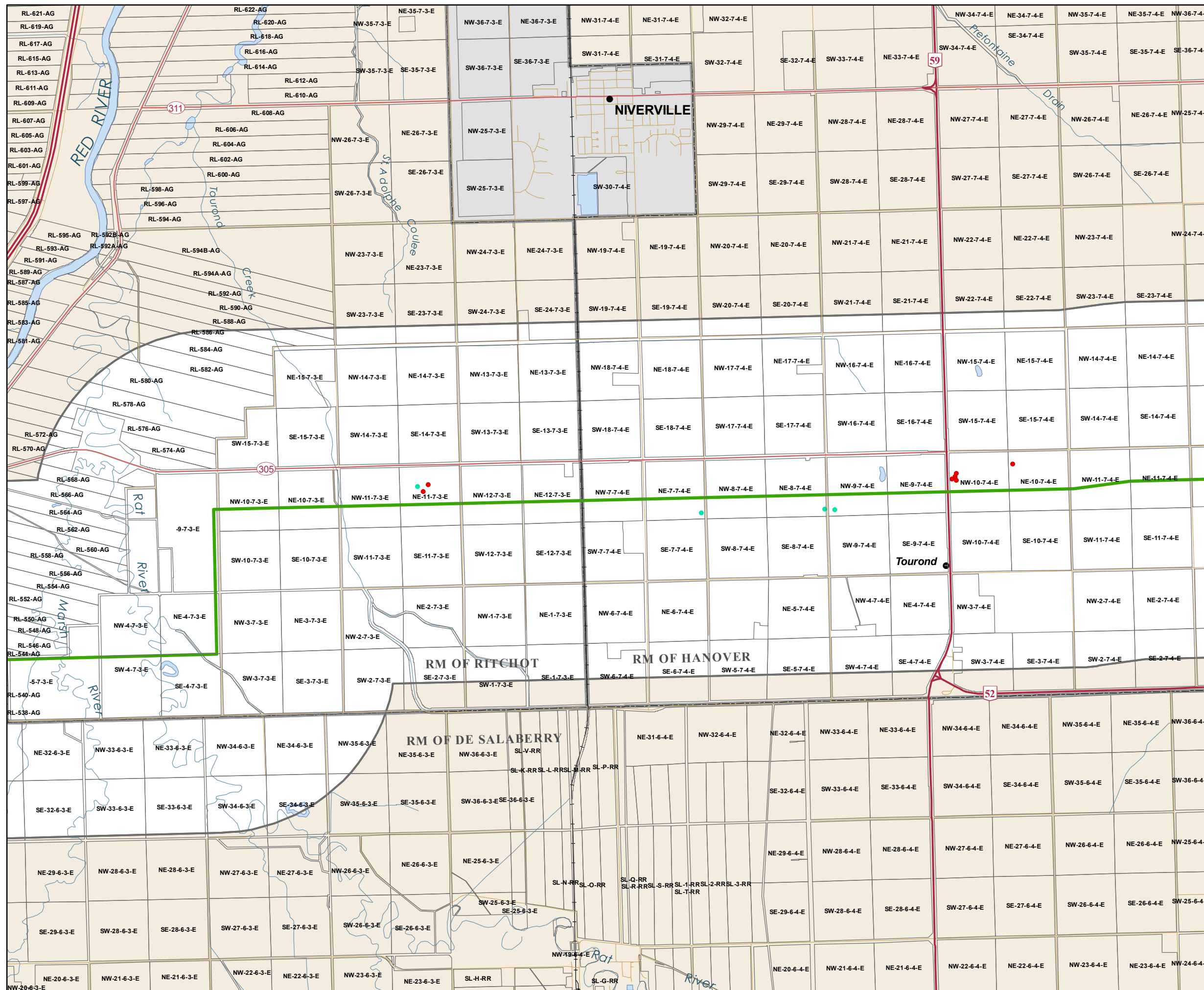

Coordinate System: UTM Zone 14N NAD83
 Data Source: MBHydro, MMM, Stantec, ProvMB, NRCAN
 J&V Nielsen
 Date Created: July 20, 2011

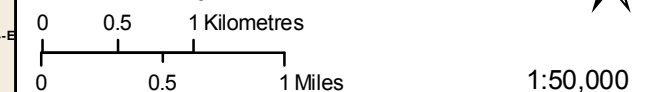

1:50,000

**Houses, Barns,
 And Structures
 Within 270 Metres Of The
 Final Preferred Route**

Bipole III Transmission Project

Project Infrastructure

- Final Preferred Route
- Converter Station
- Local Study Area

Infrastructure

- Transmission Line

Structures

- Barn
- House
- Tower

Landbase

- Community
- City / Town
- Rural Municipality
- First Nation
- National/Provincial Park
- Wildlife Management Area



Coordinate System: UTM Zone 14N NAD83
 Data Source: MBHydro, MMM, Stantec, ProvMB, NRCAN
 J&V Nielsen
 Date Created: July 20, 2011

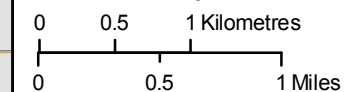

1:50,000

**Houses, Barns,
 And Structures
 Within 270 Metres Of The
 Final Preferred Route**

Bipole III Transmission Project

Project Infrastructure

- Final Preferred Route
- Converter Station
- Local Study Area

Infrastructure

- Transmission Line

Structures

- Barn
- House
- Tower

Landbase

- Community
- City / Town
- Rural Municipality
- First Nation
- National/Provincial Park
- Wildlife Management Area



Coordinate System: UTM Zone 14N NAD83
 Data Source: MBHydro, MMM, Stantec, ProvMB, NRCAN
 J&V Nielsen
 Date Created: July 20, 2011

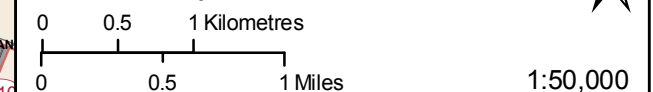

**Houses, Barns,
 And Structures
 Within 270 Metres Of The
 Final Preferred Route**

Bipole III Transmission Project

Project Infrastructure

- Final Preferred Route
- Converter Station
- Local Study Area

Infrastructure

- Transmission Line

Structures

- Barn
- House
- Tower

Landbase

- Community
- City / Town
- Rural Municipality
- First Nation
- National/Provincial Park
- Wildlife Management Area

Coordinate System: UTM Zone 14N NAD83
 Data Source: MBHydro, MMM, Stantec, ProvMB, NRCAN
 J&V Nielsen
 Date Created: July 20, 2011

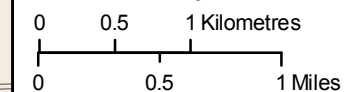

1:50,000

Houses, Barns, And Structures Within 270 Metres Of The Final Preferred Route

Map 93

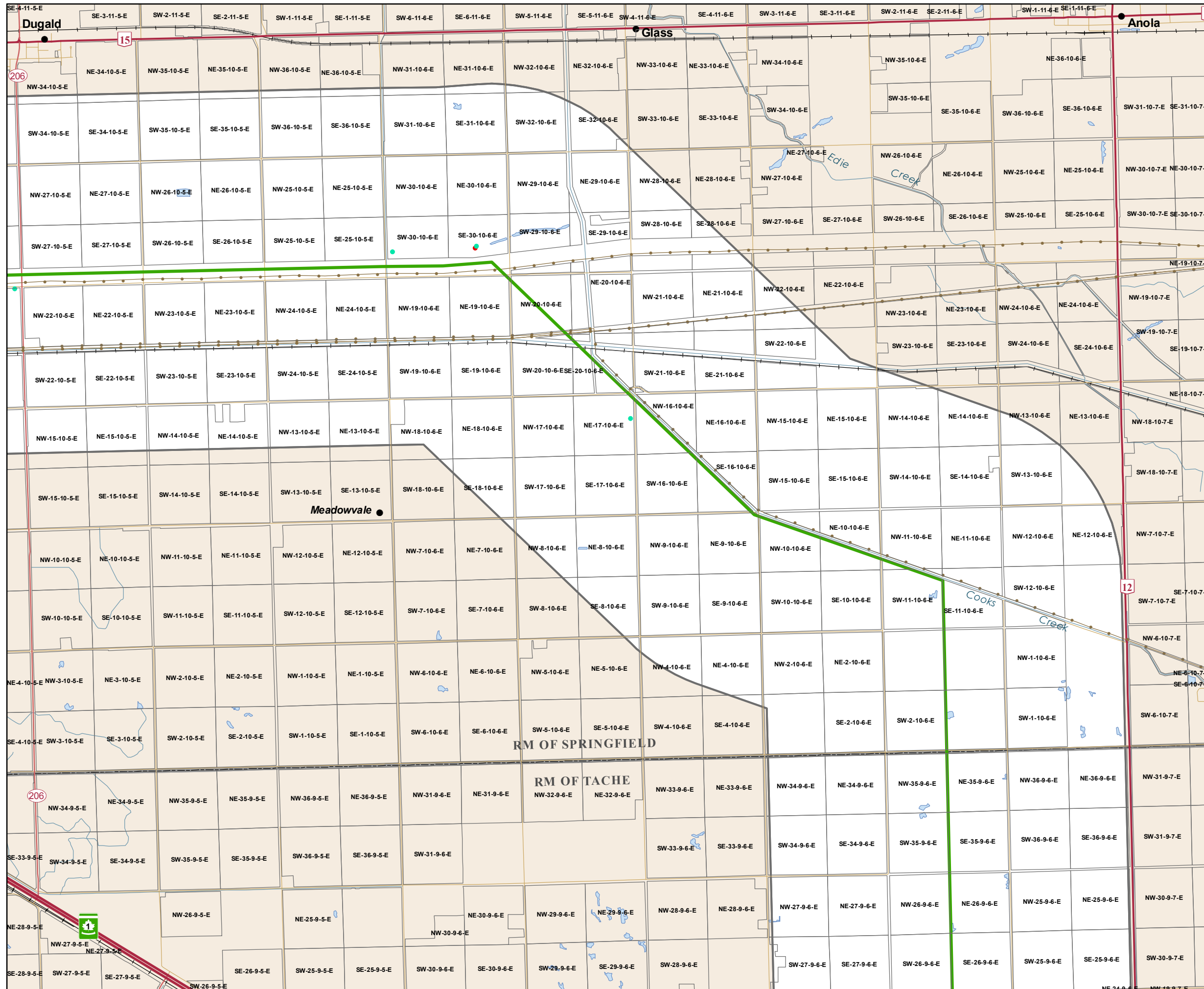

Bipole III Transmission Project

Project Infrastructure

- Final Preferred Route
- Converter Station
- Local Study Area

Infrastructure

- Transmission Line

Structures

- Barn
- House
- Tower

Landbase

- Community
- City / Town
- Rural Municipality
- First Nation
- National/Provincial Park
- Wildlife Management Area

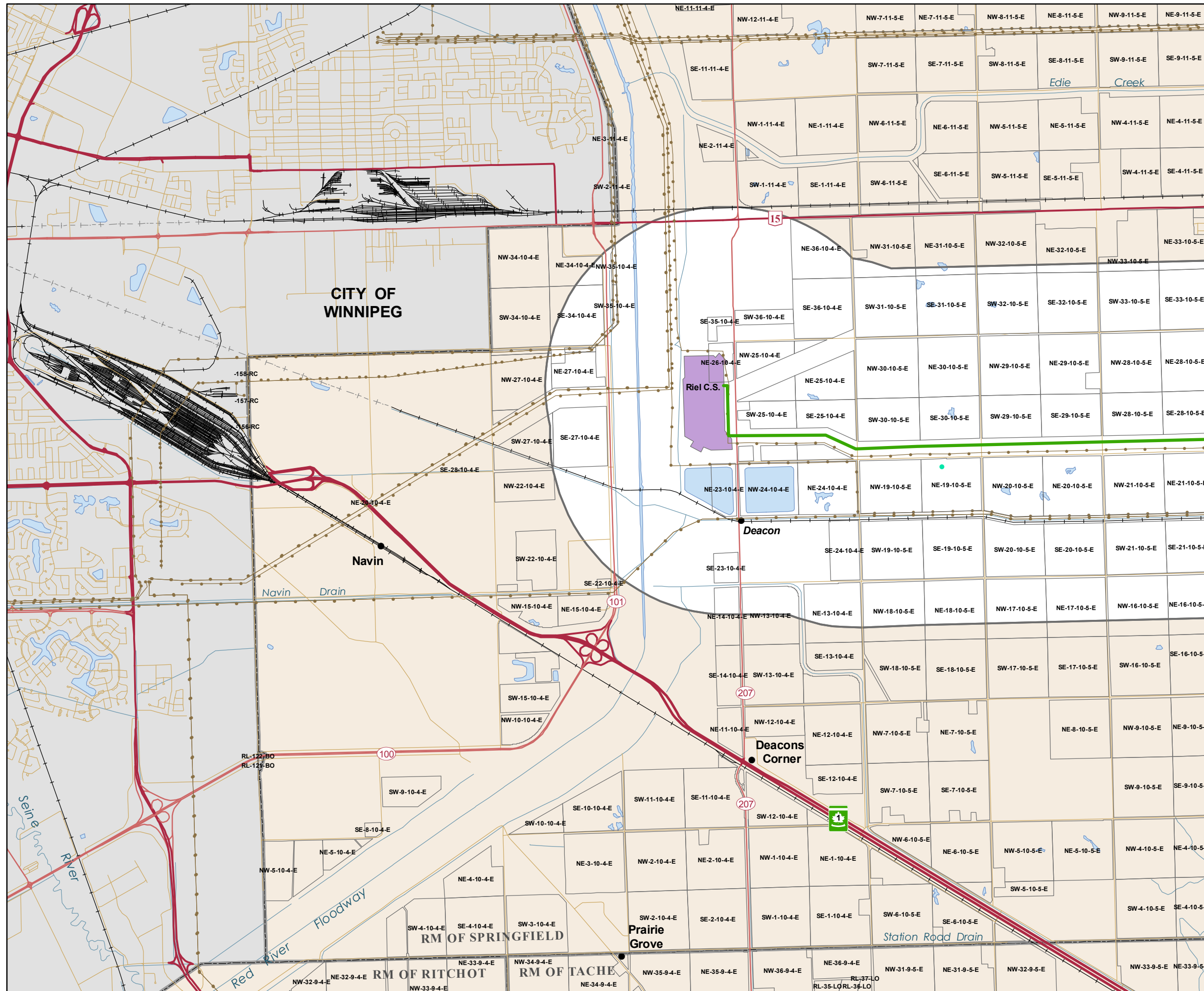

Coordinate System: UTM Zone 14N NAD83
 Data Source: MBHydro, MMM, Stantec, ProvMB, NRCAN
 J&V Nielsen
 Date Created: July 20, 2011

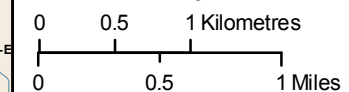

1:50,000

**Houses, Barns,
 And Structures
 Within 270 Metres Of The
 Final Preferred Route**

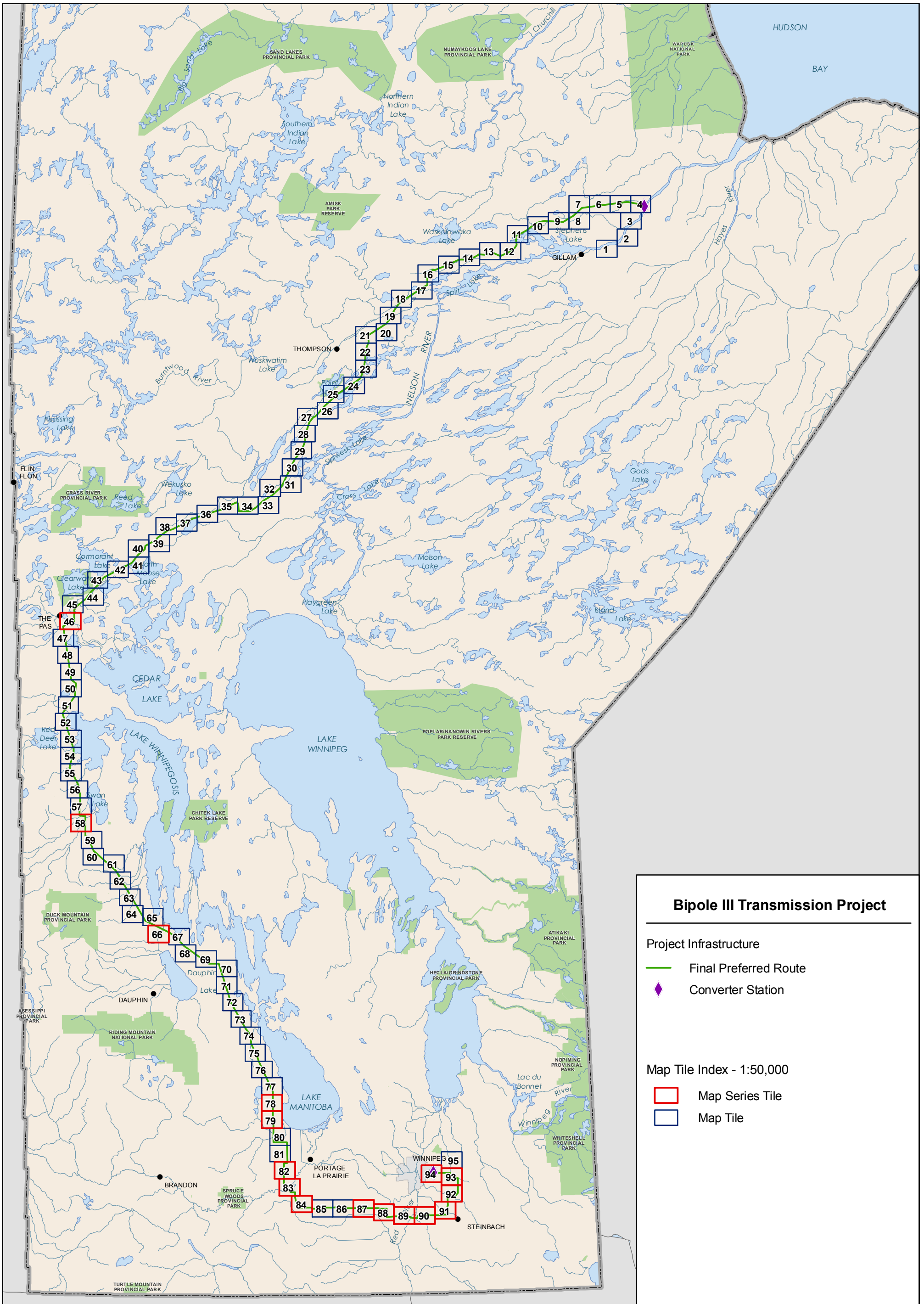

Coordinate System: UTM Zone 14N NAD83
 Data Source: MB Hydro, MMM, Stantec, ProvMB
 Date Created: June 10, 2011

0 25 50 Kilometres

0 25 50 Miles

1:2,750,000

Index of Map Series

Houses, Barns, And Structures Within 270 Metres
 Of The Final Preferred Route